

WASHER LOAD CELLS SERIES HC / RC

CANopen

Modbus

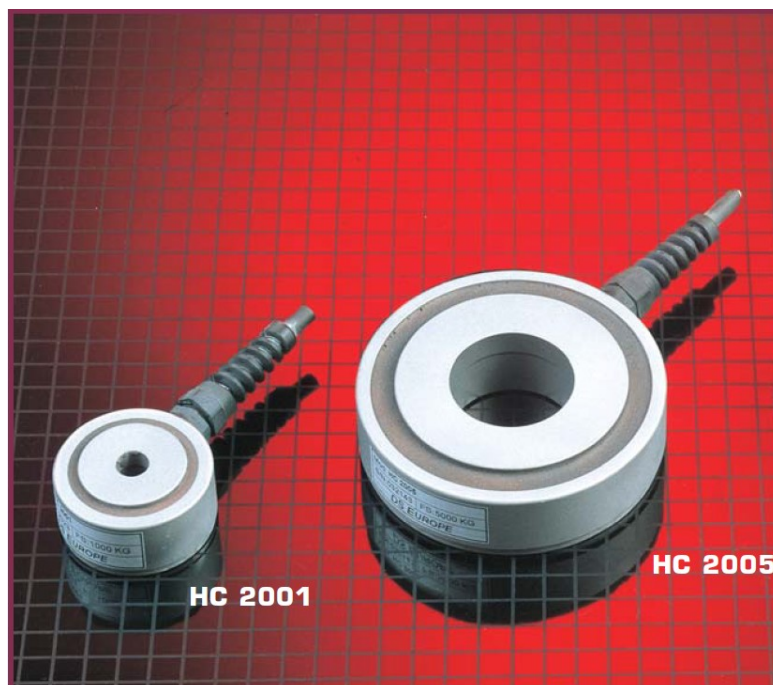

CE UK
CA

DESCRIPTION

Series HC/RC are washer load cells with a central hole, which supply an electrical signal proportional to the force applied in their axial direction.

- Low profile, compactness, high strength, easiness of installation
- Central hole diameter: Large, for standard metric shafts and screws, allowing the installation on existing machines without diameter adapters
- Internal sensors and electrical circuits: Entirely stuffed by water-repellent and high insulating silicon filler, assuring an excellent protection also for outdoor applications
- Internal calibration: To allow a simple calibration of the complete system by the user

Series HC/RC load cells can be connected to indicators and conditioners supplied by S2Tech:

- ◇ **Mod. AN401Plus:** signal conditioner and indicator with microprocessor
- ◇ **Multichannel data acquisition system mod. DSLab:** It allows to acquire signal with high resolution and sample rate and to display data on PC

Note: All the listed units, connected to the washers HC/RC, set up complete measuring systems

Series HC/RC load cells find application for indication, automatic control and feedback of static and dynamic axial thrust on punching machines; on machine tools; on presses; on power hammers installed directly or through a thrust spherical plane bearing.

TECHNICAL CHARACTERISTICS

Measuring ranges (FS): from 20 Kg to 50 ton (see table below)

Total error (non-linearity + hysteresis + sensitivity change with temperature): $\leq \pm 0,6\%$ FS

Sensitivity: 1 mV/V FS (typical)

Temperature effect on zero: $\leq \pm 0,1\%$ FS, within 5° K

Creep: $\leq \pm 0,1\%$ FS, within 4 hours at FS

Return to zero from FS: $\leq \pm 0,1\%$ FS, after 4 hours at FS

Safe load limit: 50% over FS*

Ultimate load limit: 2 times FS*

*The load must be applied on the weighing axis, uniformly distributed on the weighing and base surfaces. Thrust spherical plane bearings are advisable.

For dynamic loads, with shocks and vibrations, difficult to estimate, the max load allowed has to be reduced to avoid yielding and ruptures.

OVERALL DIMENSIONS

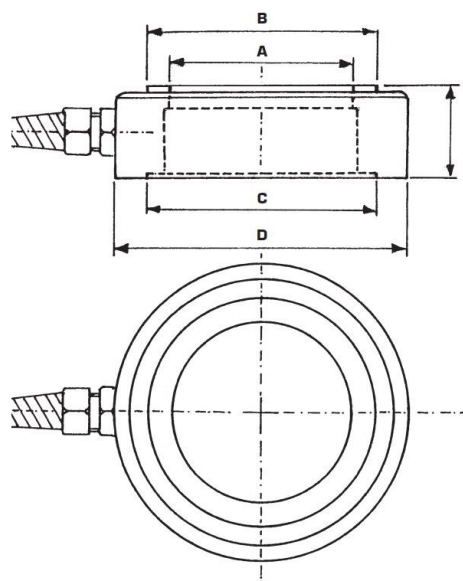

MODEL	MEASURING RANGES	DIMENSIONS (mm)				
		D	A	H	B	C
HC2001 (Al)	0 ÷ (20) - 50 - 100 - 200 - 300 Kg	50	10,1	26	34	44
HC2001 (Fe)	0 ÷ 500 - 1000 Kg	50	10,1	26	34	44
HC2002 (Fe)	0 ÷ 2 Ton	80	30,1	27,5	57	67
HC7001	0 ÷ 300 - 500 - 1000 Kg	34	8,2	26	15	22,2
HC7002	0 ÷ 2,5 Ton	48,3	16,2	30	25	34
RC5	0 a 5 Ton	80	50,1	29,5	68	80
RC10	0 ÷ 10 - 15 Ton	88	50,1	31	66,1	66,1
RC30	0 ÷ 30 Ton	110	80,1	31	97	97
HC7050 (Fe)	0 ÷ 50 Ton	130	52,2	65	101	108
HC7100 (Fe)	0 ÷ 100 Ton	180	68,5	70	132	140