

SS2/SS3

Ultra Low Force Load Cell

Features

- *Ultra-Low force range*
- *mg resolution*
- *Bonded semiconductor strain gauge technology*
- *Low deflection*
- *High stiffness and frequency response*
- *High-level output signal*
- *Robust*



Applications

- *Bio-medical investigations*
- *General force measurement in ultra low force applications*

The SS2-3 load cells have been designed for applications where precision measurement of extremely low forces is required. They are based upon bonded semi-conductor strain gauge technology, conferring excellent sensitivity and eliminating the fragility associated with unbonded strain gauge types. The design features excellent immunity to the effects of eccentric loading, side loading and bending moments. Forces may be applied either in tension or compression and alternative loading adaptors are available. The low deflection and consequent high frequency response ensures that the unit is suitable for measuring peak and transient forces. The transducer will replace the well known UC2 and UC3 range of load cells, originally marketed by Gould-Statham®, who stopped production in the 1980's.

There are many applications for this range of load cells in medical research R&D and industry.

SS2/SS3

Ultra Low Force Load Cell

Performance Specifications @ 20°C			
Type Number		SS2	SS3
Operational Mode		Bi-Directional	Compression
Full Scale Load Range	Grams	±30	60
Excitation Voltage	Volts dc	5	
Maximum Excitation Voltage	Volts dc	10	
Full Range Output (FRO)	mV/Volt	6	12
Combined Error	± % FRO	±0.5	
Operating Temperature Range	°C	-20 to +80	
Compensated Temperature Range	°C	-10 to +65	
Input Resistance	Ohms (nominal)	650	
Output Resistance	Ohms (nominal)	400	
Maximum Overload Capacity (compression)	% Full Scale	500	
Maximum Side Load	% Full Scale	100	
Maximum Deflection at Rated Load	mm (inches)	0.05 (0.002")	
Thermal Zero Shift	% FRO/°C	0.02	
Thermal Sensitivity Shift	% Reading/°C	0.02	
Documentation		Individual Calibration Data Sheet	

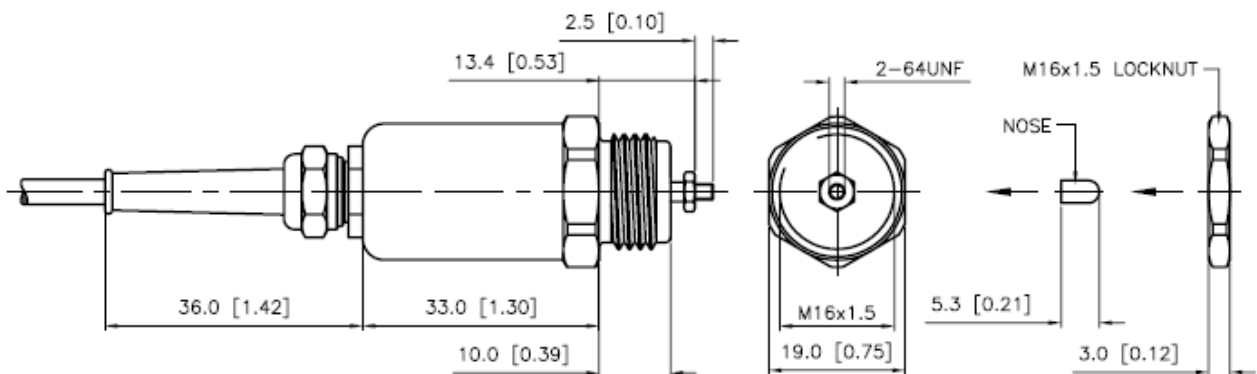

How To Order:

Order by specifying type number, e.g. SS2 or SS3

Notes:

1. Standard units are supplied with a 4 conductor, 1m shielded cable; the shield is not connected to the transducer.
2. Units are supplied as standard calibrated in compression.
3. Signal polarity is positive in compression.